

CHANGING TO A NEW FORMULA WITH YOUR INFANT

MOST HEALTHY INFANTS WILL DRINK ANY FORMULA

Keep in mind that:

- Infants switching between standard formulas may have a quicker transition.
- Mix the two formulas 50/50 for 1–3 days.
- If your infant needs to transition slower, follow the steps for formula change.
- The following steps may help infants switch from one therapeutic formula to another.
- If you have any questions or concerns, talk to your WIC staff or your doctor.

AFTER YOU FINISH

Storing prepared formula:

- These instructions may make more formula than your infant will eat in one feeding. Before feeding, separate the prepared formula into 2- to 4-oz bottles.
- Store **prepared powder formula** in the refrigerator no longer than 24 hours.
- Store **prepared concentrate or ready-to-feed formula** in the refrigerator no more than 48 hours.

STEPS FOR FORMULA CHANGE:

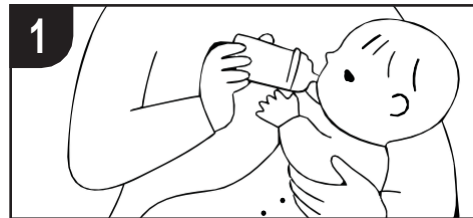

OR

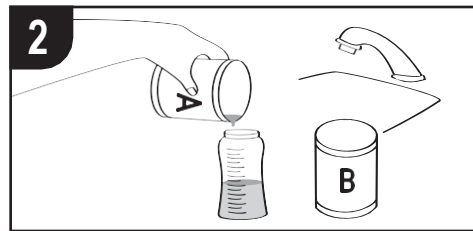

OFFER NEW FORMULA

Offer the new formula to find out if your infant accepts it. If your infant tried the new formula in the past and didn't like it, try it again. Babies mature and their taste also changes.

SLOWLY MIX IN NEW FORMULA

Begin adding a small amount of the new formula to the current formula. Each day, add more of the new formula so your infant slowly gets used to the different taste. In a week, your infant will be accepting the new formula. Follow the instructions below to slowly introduce the new formula.

TO MAKE ABOUT AN 8-OUNCE BOTTLE:

	ON DAYS 1 & 2	ON DAYS 3 & 4	ON DAYS 5 & 6	ON DAY 7
POWDERED FORMULA Depending on can size, 6–10 cans of new formula are needed to follow these steps.	MIX 8 ounces of water + 3 scoops old formula + 1 scoop new formula	MIX 8 ounces of water + 2 scoops old formula + 2 scoops new formula	MIX 8 ounces of water + 1 scoop old formula + 3 scoops new formula	Follow instructions on the new can of formula for preparation.
LIQUID CONCENTRATE FORMULA Depending on can size, 1–2 cans of new formula are needed to follow these steps. Always use the scoop that comes with the formula can.	MIX 4 ounces of water + 3 ounces old formula + 1 ounce new formula	MIX 4 ounces of water + 2 ounces old formula + 2 ounces new formula	MIX 4 ounces of water + 1 ounce old formula + 3 ounces new formula	Follow instructions on the new can of formula for preparation.



DOH 961-149 October 2022

To request this document in another format, call 1-800-525-0127. Deaf or hard of hearing customers, please call 711 (Washington Relay) or email civil.rights@doh.wa.gov.