

Guide to Adding Other Data to the EHD Map



Washington Environmental Health Disparities (EHD) Map

Background

The places where we live, work, and play affect our health – so does our social world. Aspects of these environments overlap and interact. Factors like pollution, racism, colonialism, cost of living, and pre-existing health challenges can add up and make things worse.

The primary goal of the EHD map is to identify communities most affected by environmental health risks. The tool ranks these risks by census tract, highlighting communities most burdened with the cumulative impacts of pollution. It also identifies environmental health measures by census tract, providing useful, data-driven insights for communities, policymakers, government leaders and staff, and others.

Adding Other Data

You can add other data as an overlay using the “Add Data” button.

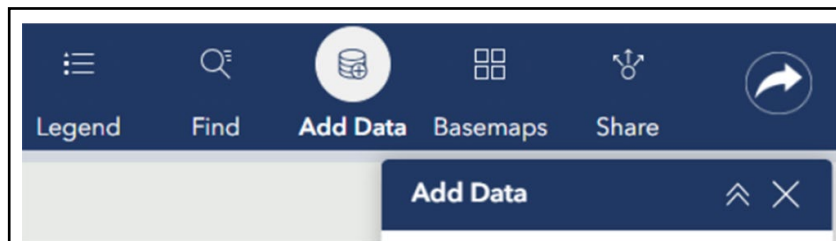

You can add data from ArcGIS Online, Living Atlas, or any external open-data platform that hosts spatial datasets. Please note that we’ve written these instructions for the dataset as it appeared in April 2026. If the U.S. Department of Housing and Urban Development (HUD) updates the dataset, the instructions may not reflect the changes.



DOH 334-614 June 2026 CS

To request this document in another format, call 1-800-525-0127. Deaf or hard of hearing customers, please call 711 (Washington Relay) or email doh.information@doh.wa.gov.

Here's an example using the [HUD open data portal](#). This site contains many datasets. Let's imagine a Department of Commerce staff in the housing division wants to understand where Housing Choice Vouchers are located. The Housing Voucher program is important because it helps vulnerable populations obtain federal funds for housing. We can combine these data with the EHD map to better understand conditions in these communities.

To add data to the EHD map, you first need to select the other data. Open the HUD Open Data portal and scroll down to select Rental Assistance Programs. Next, scroll until you find Housing Choice Vouchers by Tract and select the dataset.

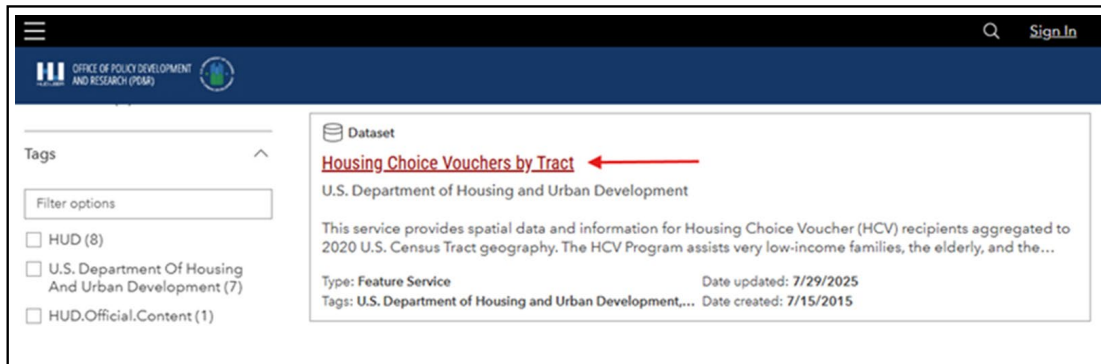

After opening the dataset, you will see the page below with several options. Select **“I want to use this”** at the bottom left-hand side.

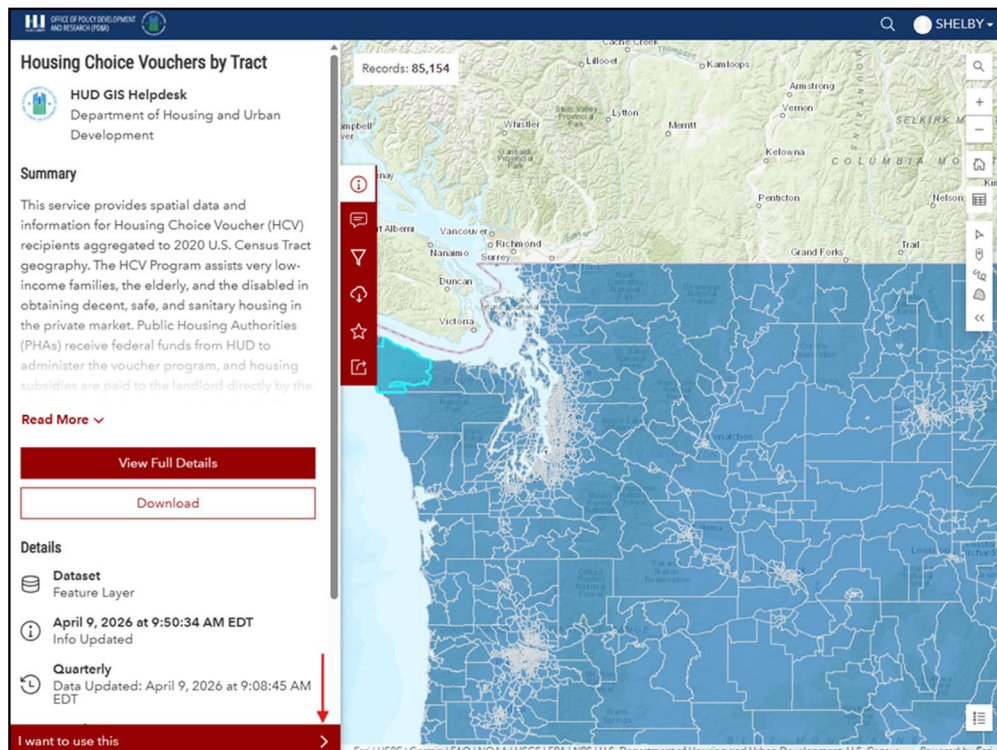

Environmental Health Disparities (EHD) Map *Guide to Adding Other Data to the Map*

Select **“View API Resources”** and then **“copy”** the URL by clicking on the clipboard with an arrow (emphasized below by the red arrow) from the **“GeoJSON”** option.

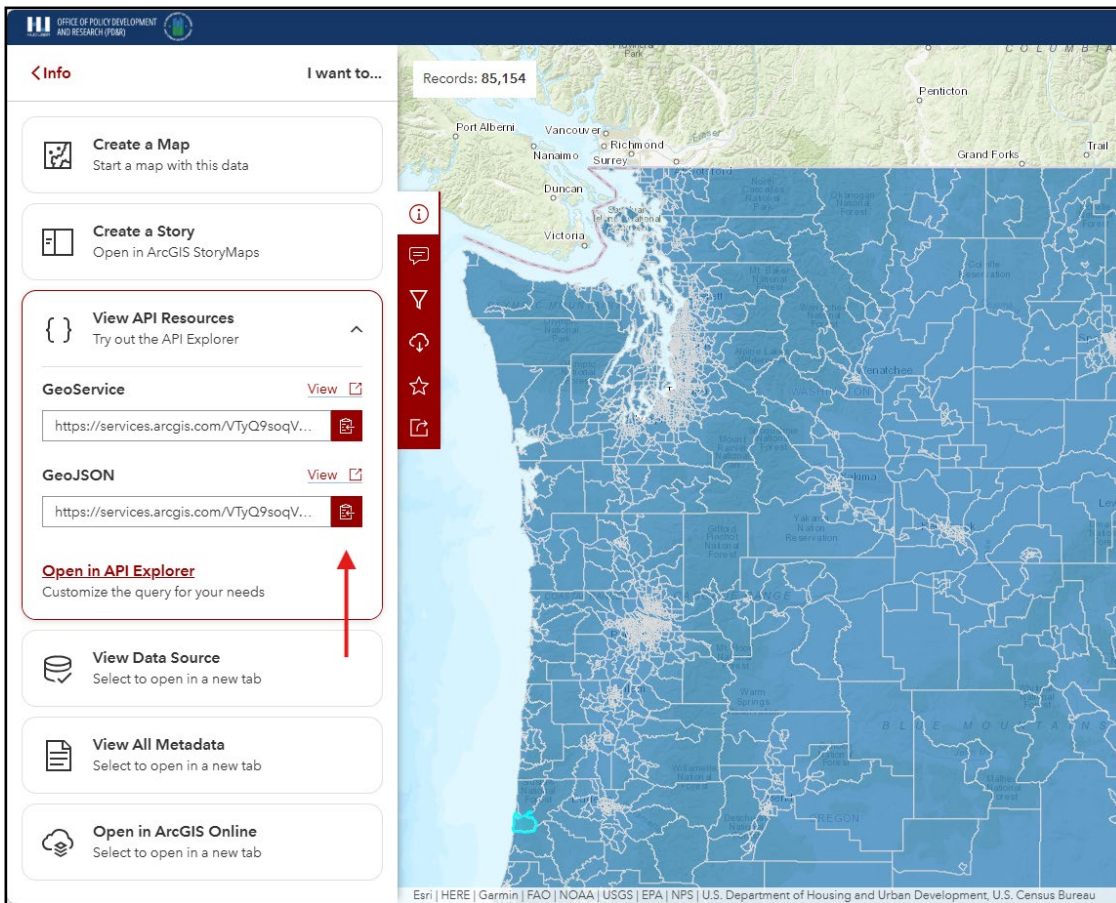

Now return to the EHD Map and select **“Add Data”** in the top left of the EHD map.

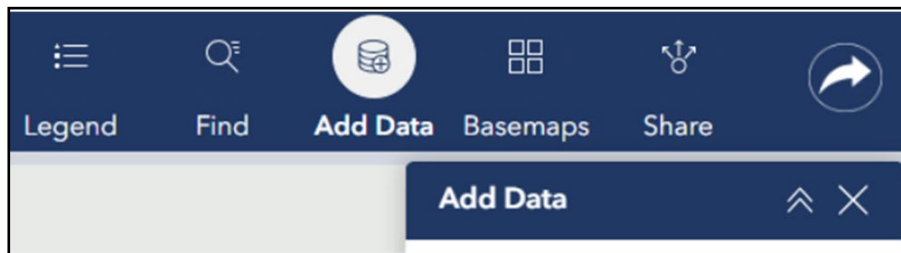

Environmental Health Disparities (EHD) Map *Guide to Adding Other Data to the Map*

Then choose the **“URL”** tab at the top.

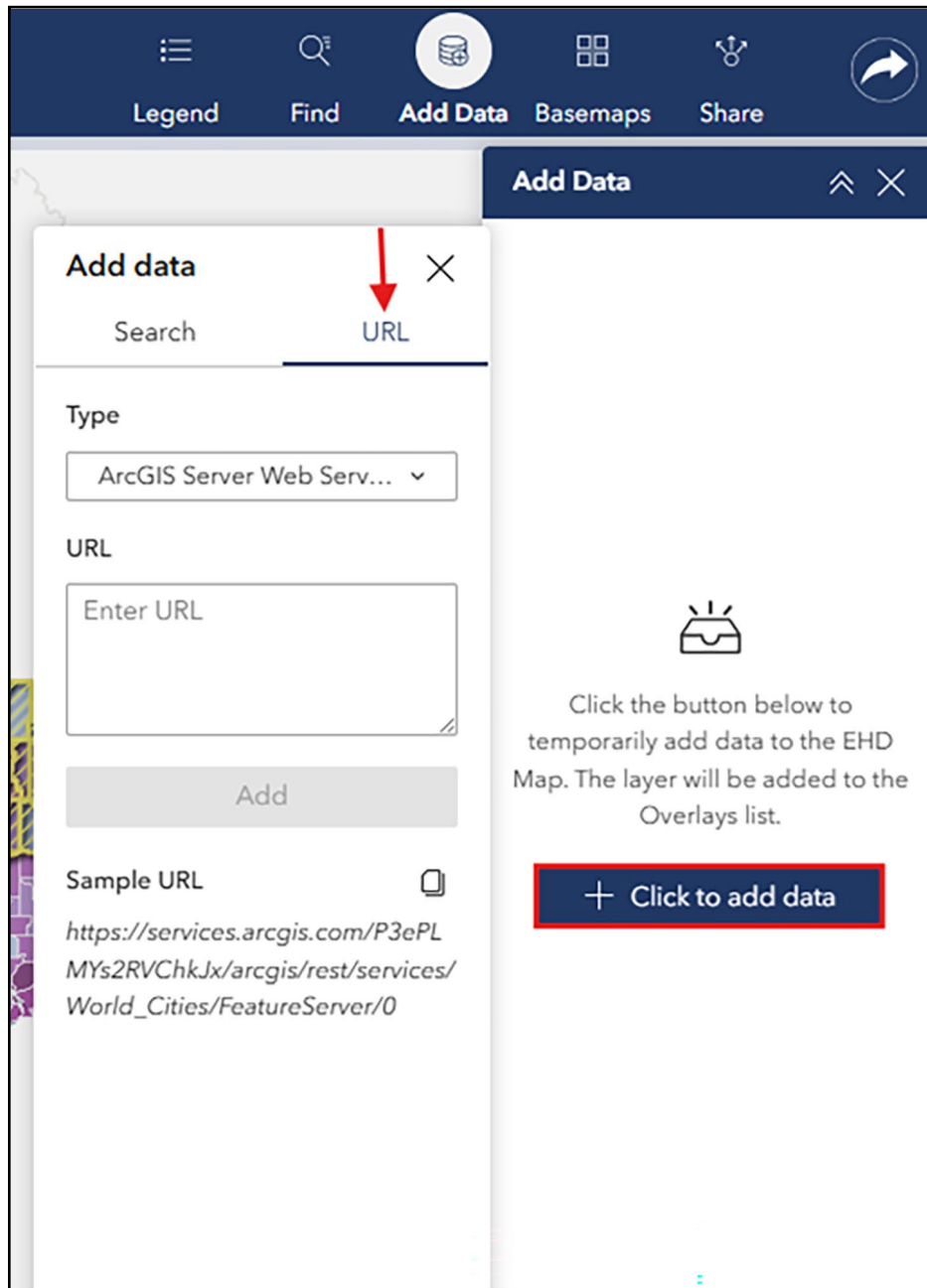

Paste the copied URL into the URL box. Make sure the URL format matches the **“Sample URL”** snippet in the blue box below. Delete the blue-highlighted part at the end of the URL.

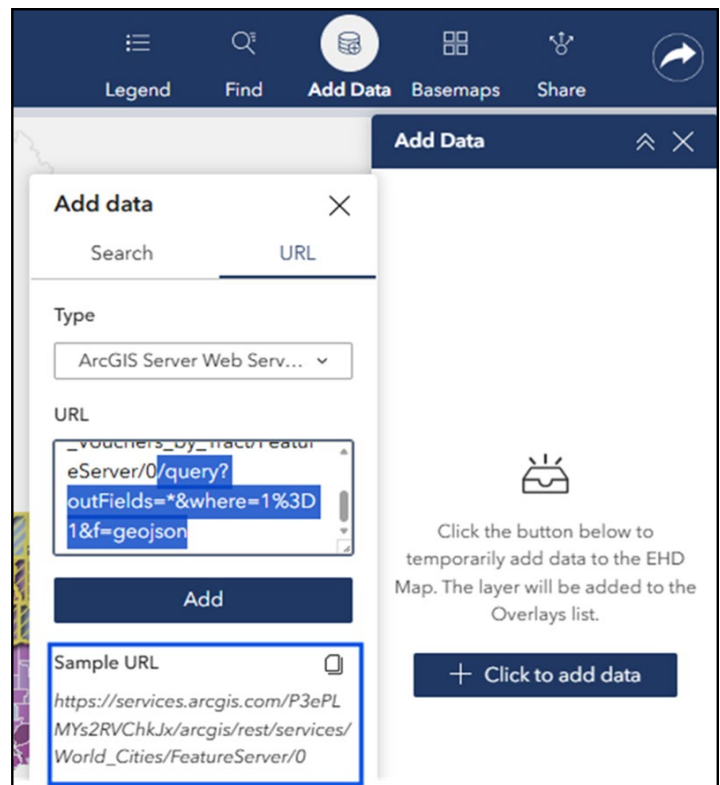

Select **“Add”** and then **“Done”**.

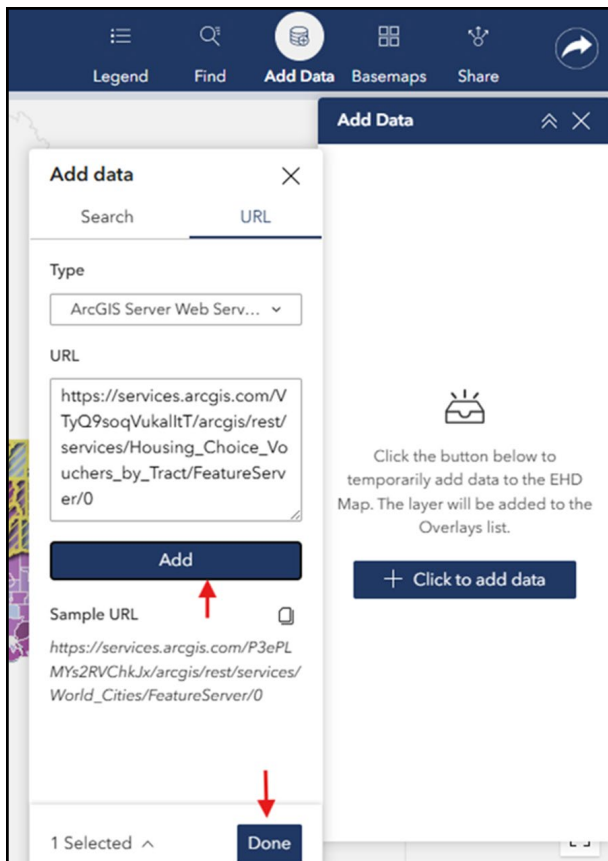

You will notice that one of the “Add data” windows closes. The EHD map will zoom far out.

You can select the “home” button to return to viewing Washington state. You will see a new window on the left where the map has added your overlay, feature layer, or dataset. The new data layer you just added will appear at the top of the “Overlay” drop-down.

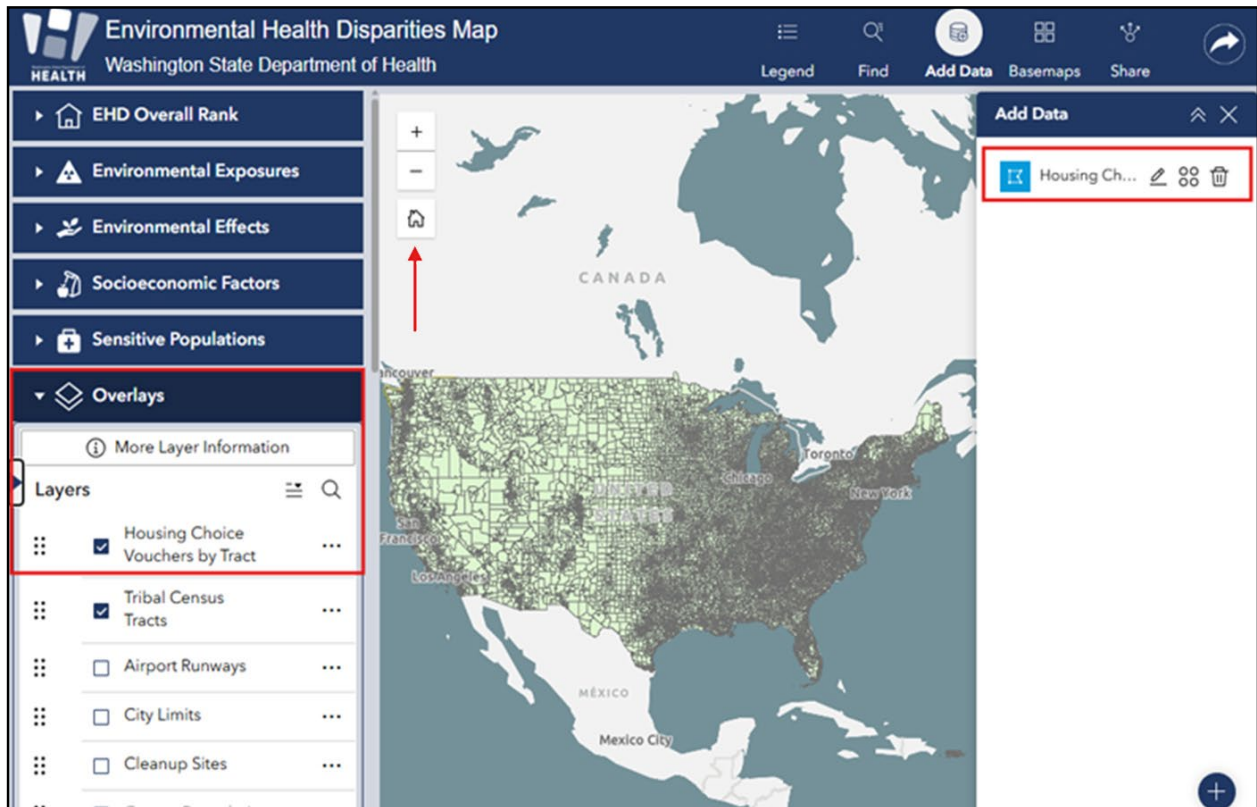

You can also change the name of your added data by selecting the pencil icon in the “Add Data” pop-up. Renaming the data could be helpful if you plan on adding multiple datasets from external sources.

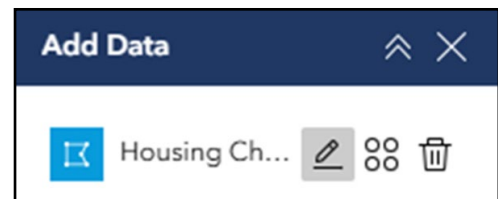

Since this dataset is for the entire U.S., you'll want to limit it to Washington state when using it with the EHD map. To do this, select the 3 black dots next to the layer name on the left and then select **"Set filter"**.

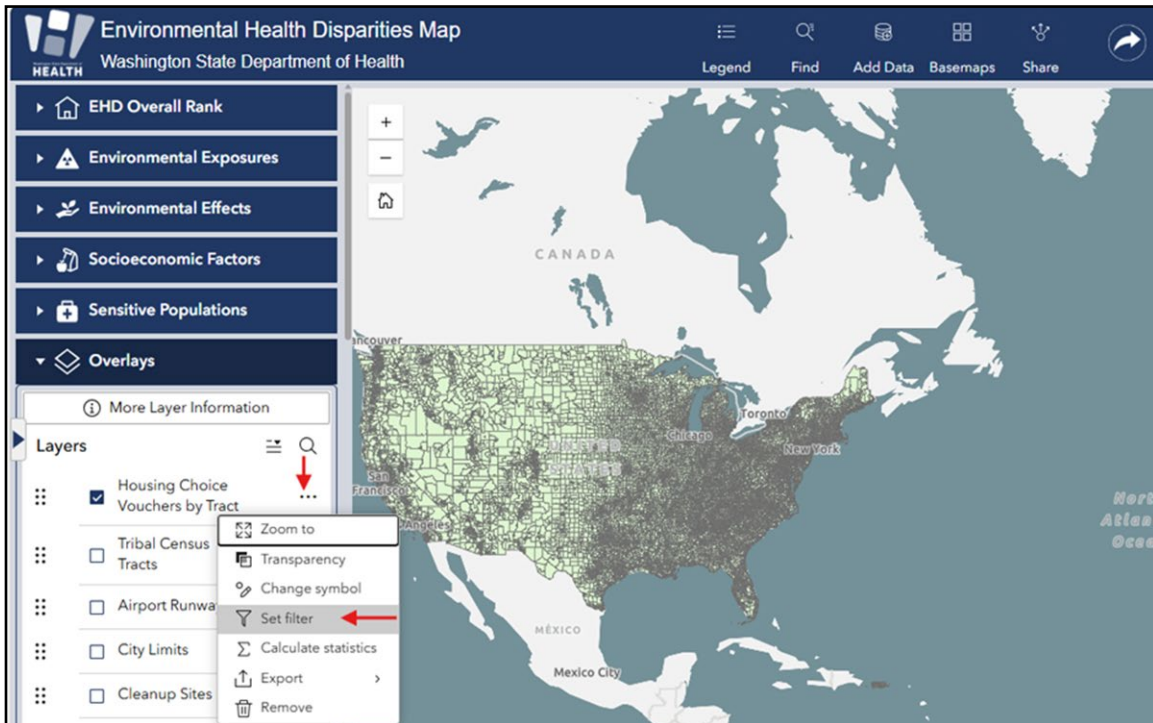

Select the **"Add"** button and then select **"Clause set"**.

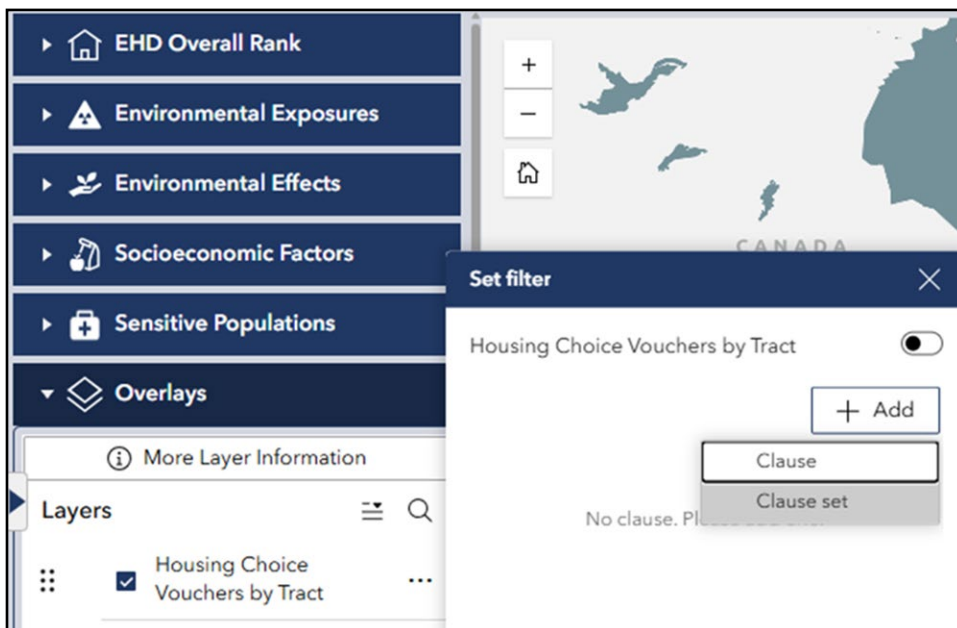

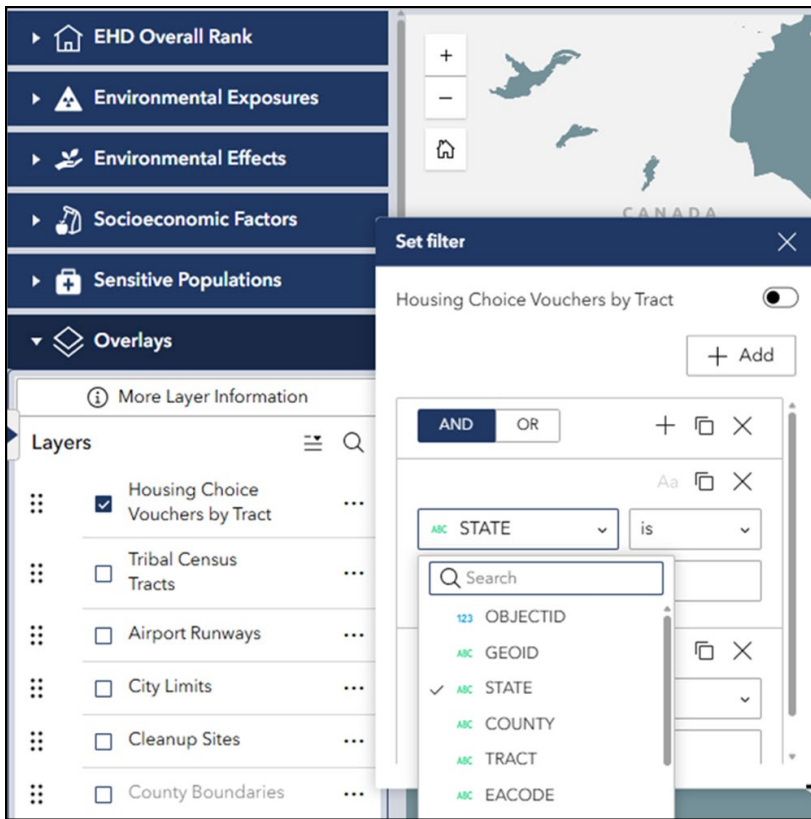

From the attribute drop-down menu, choose the field that represents **“state”**.

Enter the Washington state FIPS number, **“53”**. In the next clause, select **“HCV_PUBLIC_PCT”**. This field shows you how much of the tract qualifies for housing vouchers.

This dataset shows all tracks regardless of whether they have any vouchers. So, you might be interested in looking at a specific percentage. For this example, select **“greater than”** and then type **“10”**.

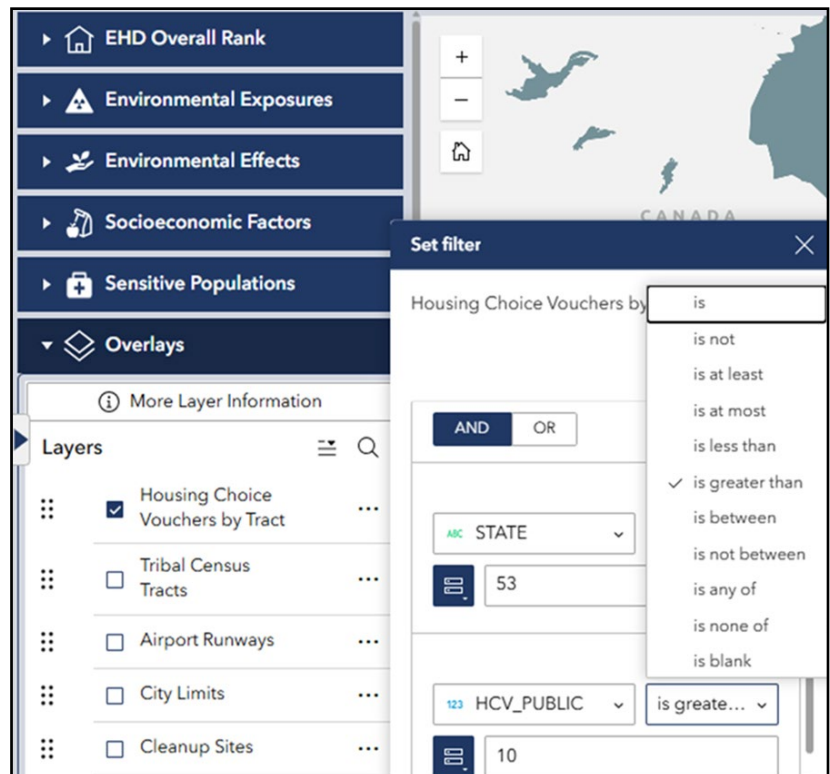

Then select the toggle at the top right-hand side of the window.

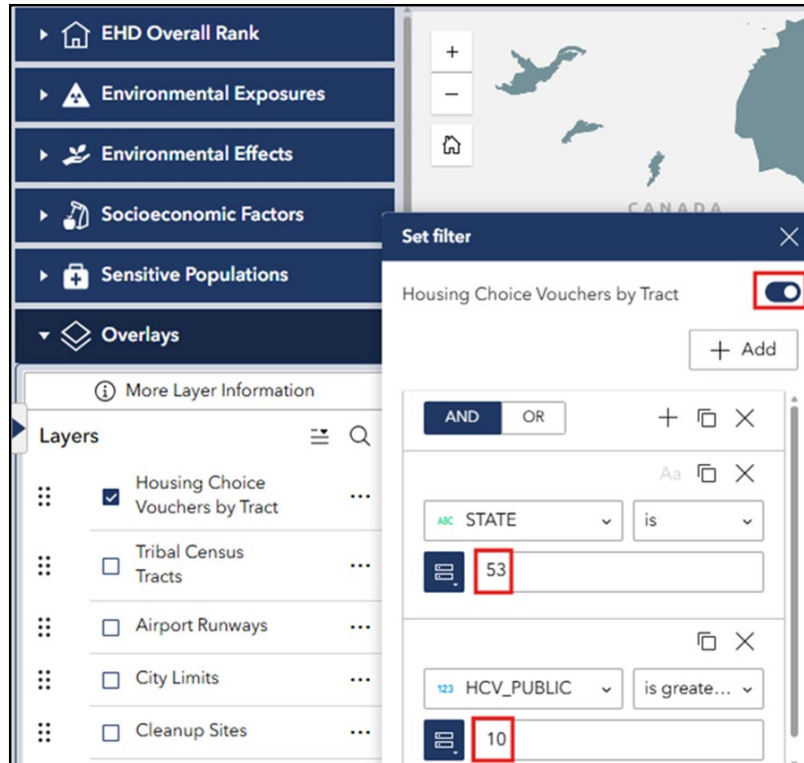

Census tracts where Housing Choice Vouchers (HCV) make up more than 10% of renter-occupied housing units are now displayed across Washington state. You can research the areas where these vouchers are.

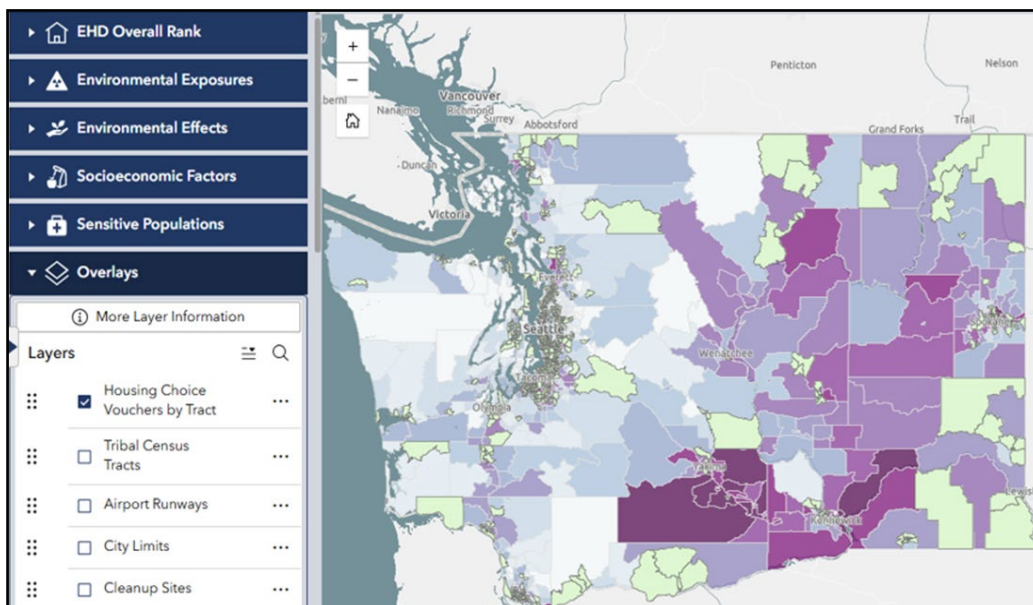

You can adjust the transparency of the added data by selecting the 3 black dots again and selecting **“Transparency”**. This makes it easier to see the EHD Map data under your added dataset.

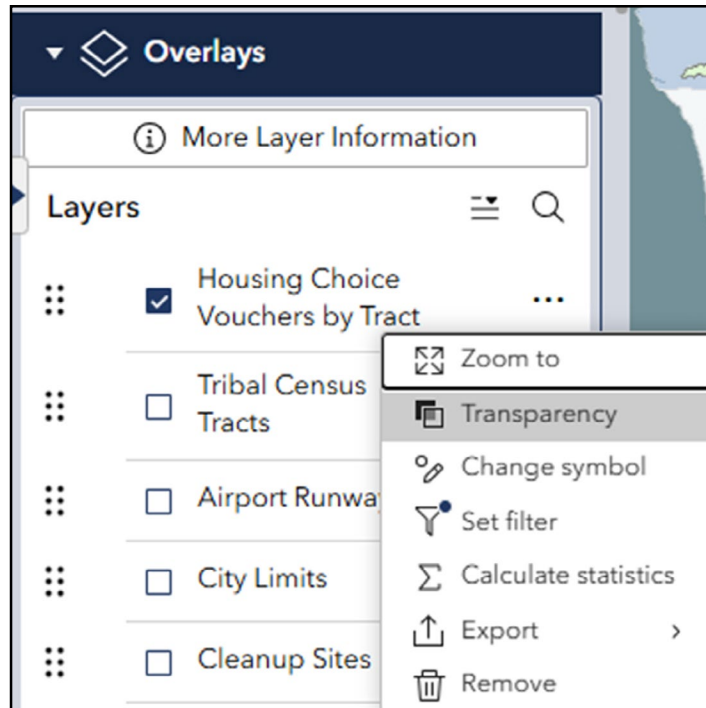

If you want to remove the overlay that you've added, you have 2 options:

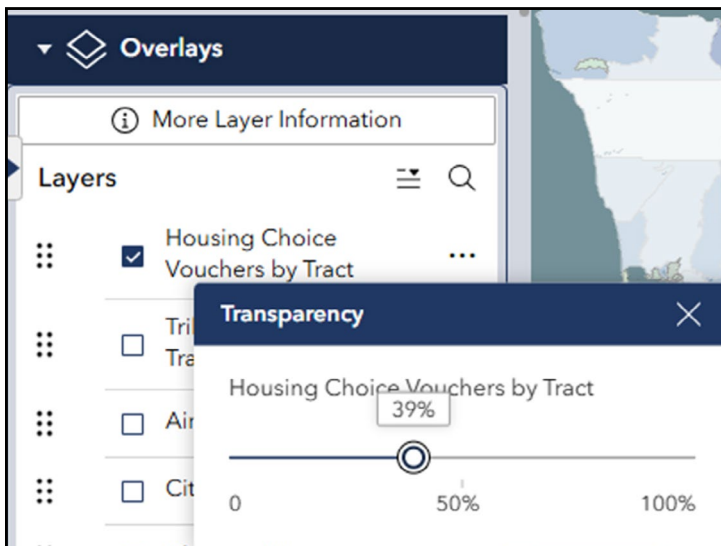

1.) You can remove it by clicking the 3 black dots and selecting the **“Remove”** option.

2.) Or you can go to the **“Add Data”** pop-up and select the trash icon on the right.

